

P
Paulmann

URail 230V

Chrome matt / White / Chrome



LED

*Energy
Saver*

*Halogen
12V*

*Halogen
230V*



www.paulmann.com/urail/all



Paulmann EcoSystems

LED

⚡ -80%

💡 10.000h - 25.000h

Paulmann EcoSystems

Energy Saver

⚡ -80%

💡 5.000 - 8.000h

Paulmann EcoSystems

Halogen 12V

⚡ -50%

💡 3.000h

Paulmann EcoSystems

Halogen 230V

⚡ -25%

💡 2.000h

LED

▶ warm white
2700-3000K



Channel < A++-A >
1x10W 433 lm
∅50 ↔161 ∅150 mm
C 951.11



Channel < A++-A >
1x10W 433 lm
∅50 ↔161 ∅150 mm
W 951.12



Channel < A++-A >
1x10W 433 lm
∅50 ↔161 ∅150 mm
C 951.13



Vision < A++-A >
1x3W 140 lm
∅125 ↔145 ∅147mm
CM 951.14



TectLed < A++-A >
2x9W 2x350 lm
∅85 ↔170 ∅160 mm
CM 950.88
W 951.64



TectLed < A++-A >
1x3W 350 lm
∅85 ↔105 ∅160mm
CM 950.87
W 951.63



Zyfi < A++-A >
1x3W 140 lm
∅125 ∅180 ø80mm
C 950.96

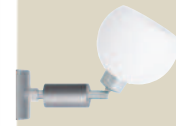

Wolbi < A++-A >
1x3W 140 lm
∅125 ∅180 ø90mm
CM 950.97
C 950.98



Linear < A++-A >
2x6W 2x500 lm
∅65 ↔220 ∅125 mm
CM 950.38



LEDmanz 1 < A++-A >
1x3W 250 lm
∅80 ∅165 ø55mm
CM 950.36

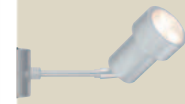

LEDmanz 2 < A++-A >
1x3W 250 lm
∅100 ∅150 ø55 mm
CM 950.37

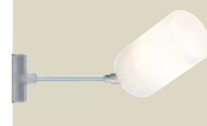
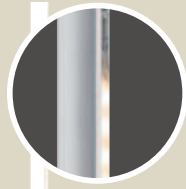

Kundry < A++-E >
1x3.5W 245 lm, GU10 <A>
230V
∅140 ∅175 ø60mm
CM 951.17



Quad < A++-E >
1x3.5W 245 lm, GU10 <A>
230V
∅135 ∅150 ø100mm
CM 951.18



Phara < A++-E >
1x3.5W 245 lm, GU10 <A>
230V
∅145 ∅180 ø75 mm
CM 951.19



Spot Inline < A++-E >
1x2W 40 lm
230V
∅18 ∅276 ø7 mm
CM 951.29



LED Tropfen GU10
3W, GU10 <A>
250 lm, 2700K
282.24



Maxiflood
3.5W, GZ10 <A>
250 lm, 2700K
281.87

Halogen
230V



Dimmable
Intensité variable



Barelli < D-E >
incl. 1x50W, GU10 <D>
∅100 ∅165 ø51 mm
CM 968.46
W 950.08
C 950.09



Barelli < D-E >
incl. 1x40W, GZ10 <D>
∅105 ∅175 ø85 mm
CM 968.47
W 976.93
C 968.73



Roncalti < D-E >
incl. 1x50W, GU10 <D>
∅105 ∅200 ø111 mm
CM 968.45
W 976.91
C 968.83



Klingsor < D-E >
incl. 1x50W, GU10 <D>
∅145 ∅170 ø51 mm
CM 968.43



Titturel < D-E >
incl. 1x42W, G9 <D>
∅150 ∅225 ø60 mm
CM 968.41
W 976.89
C 968.77



Amfortas < D-E >
incl. 1x42W, G9 <D>
∅140 ∅225 ø60 mm
CM 968.40



Kundry < D-E >
incl. 1x40W, GZ10 <D>
∅120 ∅200 ø60 mm
CM 968.42



Zambaloni < D-E >
incl. 1x40W, GZ10 <D>
∅120 ∅160 ø112 mm
CM 968.50



Spot Rumas < D-E >
incl. 1x40W, GU10 <D>
∅120 ∅115 ø55 mm
W 951.74



Spot Mega < D-E >
incl. 1x40W, GU10 <D>
∅95 ∅165 ø70 mm
CM 951.68
W 951.70



Spot Ring < D-E >
incl. 1x40W, GU10 <D>
∅120 ∅200 ø85 mm
CM 951.72



Pharus < A-B >
incl. 1x9W, E14
∅225 ∅95 ∅150 mm
CM 968.49



Pherus < A-B >
incl. 1x9W, E14
∅120 ∅160 ø40 mm
CM 976.66
W 950.06
C 968.79



Circular < A-A >
incl. 1x22W, 2GX13 <A>
∅245 ∅115 ø230 mm
CM 976.74



Techno < B-D >
incl. 1x50W, GU5.3
230V/12V, 70VA
∅83 ∅112 ∅180 mm
CM 950.89
W 951.65



Techno < B-D >
incl. 2x35W, GU5.3
230V/12V, 70VA
∅83 ∅183 ∅180 mm
CM 950.90
W 951.66



Gurnemanz < B-D >
incl. 1x50W, GU5.3
230V/12V, 60VA
∅85 ∅165 ø51 mm
CM 968.44
W 953.13

Energy
Saver

Halogen
12V



Halogen 230V

Dimmbar
Dimmable
Intensité variable

Sarrasani < D-E
incl. 1x40W, GZ10 (D)
ø135cm
CM 950.91

Phil < D-E
incl. 1x42W, G9 (D)
ø125 mm ø90-170cm
CM 968.55

Sarrasani < D-E
incl. 1x40W, GZ10 (D)
ø135cm
CM 950.92



Pendant adapter
ø135 ø26 mm
CM 974.74

Pendant adapter
ø90 ø22 mm
CM 950.00
W 950.02
C 950.01

max. ø 1 m ø 6 mm

max. 3 kg

max. 1,5 kg

- URail Pendel werkzeuglos kürzen
- La suspension URail se raccourcit sans outil
- URail pendant can be shortened without a tool
- Pendel kann neben der Schiene platziert werden
- Pendant can be positioned beside the rail
- Integration von Pendelleuchten anderer Hersteller in Ihr Paulmann URail System
- Integration of pendant lamps from other manufacturers into your Paulmann URail System
- La suspension peut être placée à côté du rail
- Intégration des suspensions d'autres fabricants dans votre système URail Paulmann

Basic + **Deco** =



LED

DecoSystems Basic-Spot < A-A
1x3W 140 lm
ø65 ø150 ø40 mm
CM 950.39

Energy Saver

DecoSystems Basic-Spot < A-B
incl. 1x9W, GZ10/GU10 (E)
ø50 ø125 ø51 mm
CM 950.22
W 950.23
C 950.24

DecoSystems Basic-Pendulum < A-B
incl. 1x9W, GZ10/GU10 (E)
ø135 cm
CM 950.10
W 950.11



Halogen 230V

Dimmbar
Dimmable
Intensité variable

DecoSystems Basic-Spot < D-E
incl. 1x40W, GZ10 (D)
ø50 ø125 ø51 mm
CM 950.19
W 950.20
C 950.21

DecoSystems Basic-Pendulum < D-E
incl. 1x40W, GZ10 (D)
ø135 cm
CM 950.13
W 950.14
C 950.15

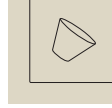

	Wolbi ø80 ø90 mm 600.07*		Zyli ø80 ø70 mm 600.04*		Keqi ø80 ø110 mm 600.12*
	Wolbi ø80 ø90 mm 600.08**3		Zyli ø80 ø70 mm 600.05*		Keqi ø80 ø110 mm 600.14*
	Wolbi ø80 ø90 mm 600.09**3		Zyli ø80 ø70 mm 600.06*		
	Wolbi ø80 ø90 mm 600.11*		Zyli ø80 ø70 mm 600.53*		
	Wolbi ø80 ø90 mm 600.16*		Zyli ø80 ø70 mm 600.54*		
	Wolbi ø80 ø90 mm 600.56**2		Quad ø80 ø75 mm 600.15*		
	Wolbi ø80 ø90 mm 600.55*				

* Glas
Glass
Verre

** Keramik
Ceramic
Céramique

** Metall
Metal
Metal

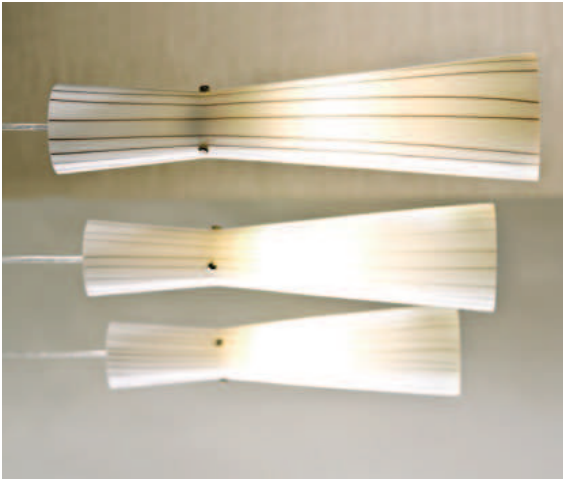

Basic Deco Energy Saver

2Easy Basic-Pendulum A-B
incl. 1x1W, E27 (E)
∅150 cm

CM 950.03 W 950.05 C 950.04

Decke Ceiling Plafond

Stange nicht kürzbar
Rod cannot be shortened
Rail tailla fixe

Wand Wall Mur

	Spira ∅280 ∅100mm 701.77*		Volta ∅280 ∅130mm 998.64*		Arazzo ∅280 ∅80mm 700.02*		Biodola ∅385 ∅120mm 700.01*		Biodola ∅450 ∅120mm 998.44*		Biodola ∅450 ∅120mm 998.43*		Livo ∅280 ∅75mm 998.42*
	Biodola ∅320 ∅115mm 700.00*		Alura ∅280 ∅85mm 998.60 ³ *		Livo ∅280 ∅75mm 998.41*		Biodola ∅280 ∅100mm 998.47*		Biodola ∅280 ∅100mm 998.48*		Fabro ∅280 ∅100mm 998.48*		Fabro ∅280 ∅100mm 998.48*

* Glas Glass
* Metall Metal
* Verre Verre

14 **Cover strip**
∅10mm ⇔ 0,68m
951.26

15 **Cable Feed**
max. 1000W, 230V
∅10mm ⇔ 0,68m
CM 951.25

not incl. Line Connector

13

IR Dimmer/Switch
500W Kanal 3+2
1000W Kanal 3+4
∅18 ⇔ 18 ∅240 mm
CM 950.70 W 950.71 C 950.72

IR Remote Control
∅40 ⇔ 7 ∅85 mm
950.73

- ▶ Fernbedienung zum komfortablen Schalten oder Dimmen von URail Systemen.
- ▶ Der in einem Verbindungsstück integrierte Empfänger steuert alle nachfolgenden Systemabschnitte.
- ▶ Über die vier Funktions Tasten der Fernbedienung können 2 getrennte Schaltungen oder 2 Dimmvorgänge gesteuert werden.
- ▶ Remote control for convenient switching or dimming of URail systems.
- ▶ The receiver integrated in an adaptor controls all following system segments.
- ▶ The four function buttons of the remote control can be used to control two separate switches and two dimming processes.
- ▶ Télécommande permettant de piloter l'éclairage de votre système URail et d'en faire varier l'intensité.
- ▶ Un capteur permet de commander un circuit complet URail.
- ▶ La télécommande permet de piloter et faire varier l'intensité jusqu'à 2 circuits différents.

1

CM	975.99	X
W	976.88	X
C	968.67	X

Suspension
 $\varnothing 105 \varnothing 23\text{mm}$

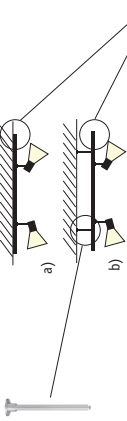

2

CM	950.86	X
----	--------	---

Track 0.1m

CM	968.54	X
W	976.82	X
C	968.64	X

Track 0.5 m

CM	968.33	X
W	976.83	X
C	968.65	X

Track 1.0 m

CM	968.34	X
W	976.84	X
C	968.66	X

Track 2.0 m

CM	968.34	X
W	976.84	X
C	968.66	X

Track 1.0 m
 $\varnothing 18\text{mm} \varnothing 18\text{mm}$

3

CM	976.55	X
W	976.85	X
C	968.70	X

End feed
 $\varnothing 18 \leftrightarrow 161 \varnothing 18\text{mm}$

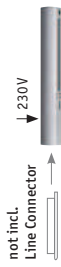

CM	968.34	X
W	976.84	X
C	968.66	X

not incl. Line Connector

4

CM	968.85	X
W	968.86	X
C	968.87	X

Middle/End feed
 $\varnothing 45 \leftrightarrow 205 \varnothing 27\text{mm}$



CM	968.34	X
W	976.84	X
C	968.66	X

not incl. Line Connector

5

CM	968.31	X
W	976.79	X
C	968.63	X

Middle/End feed
 $\varnothing 165 \varnothing 30\text{mm} \leftrightarrow 1\text{m}$
 $\varnothing 75\text{mm}$



CM	968.34	X
W	976.84	X
C	968.66	X

not incl. Line Connector

6

CM	968.51	X
W	976.81	X
C	968.68	X

Flex Connector
 a) $\varnothing 18 \leftrightarrow 180 \varnothing 18\text{mm}$
 b) $\varnothing 18 \leftrightarrow 109 \varnothing 18\text{mm}$

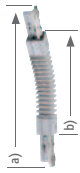

CM	968.34	X
W	976.84	X
C	968.66	X

not incl. Line Connector

7

CM	968.88	X
W	968.89	X
C	968.90	X

MAX Flex Connector
 a) $\varnothing 18 \leftrightarrow 436 \varnothing 18\text{mm}$
 b) $\varnothing 18 \leftrightarrow 366 \varnothing 18\text{mm}$

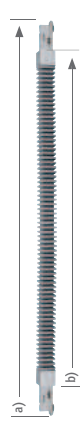

CM	968.34	X
W	976.84	X
C	968.66	X

not incl. Line Connector

8

CM	951.36	X
----	--------	---

Line Connector
 $\varnothing 11 \leftrightarrow 70 \varnothing 15\text{mm}$



CM	968.34	X
W	976.84	X
C	968.66	X

not incl. Line Connector

9

CM	976.48	X
W	976.49	X
C	976.50	X

L-Connector
 a) $\varnothing 62 \leftrightarrow 62 \varnothing 18\text{mm}$
 b) $\varnothing 29 \leftrightarrow 29 \varnothing 18\text{mm}$



CM	968.34	X
W	976.84	X
C	968.66	X

not incl. Line Connector

10

CM	976.56	X
W	976.86	X
C	968.71	X

T-Connector
 a) $\varnothing 62 \leftrightarrow 104 \varnothing 18\text{mm}$
 b) $\varnothing 29 \leftrightarrow 36 \varnothing 18\text{mm}$

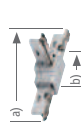

CM	968.34	X
W	976.84	X
C	968.66	X

not incl. Line Connector

11

CM	976.57	X
W	976.87	X
C	968.72	X

X-Connector
 a) $\varnothing 104 \leftrightarrow 104 \varnothing 18\text{mm}$
 b) $\varnothing 36 \leftrightarrow 36 \varnothing 18\text{mm}$



CM	968.34	X
W	976.84	X
C	968.66	X

not incl. Line Connector

12

CM	951.40	X
----	--------	---

Line Isolator
 $\varnothing 18 \leftrightarrow 70 \varnothing 18\text{mm}$

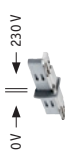

CM	968.34	X
W	976.84	X
C	968.66	X

not incl. Line Connector

13

CM	950.70	X
W	950.71	X
C	950.72	X

IR Switch
 max. 500W
 a) $\varnothing 18 \leftrightarrow 240 \varnothing 18\text{mm}$
 b) $\varnothing 18 \leftrightarrow 180 \varnothing 18\text{mm}$



CM	950.73	X
----	--------	---

IR Remote Control
 $\varnothing 40 \leftrightarrow 7 \varnothing 85\text{mm}$

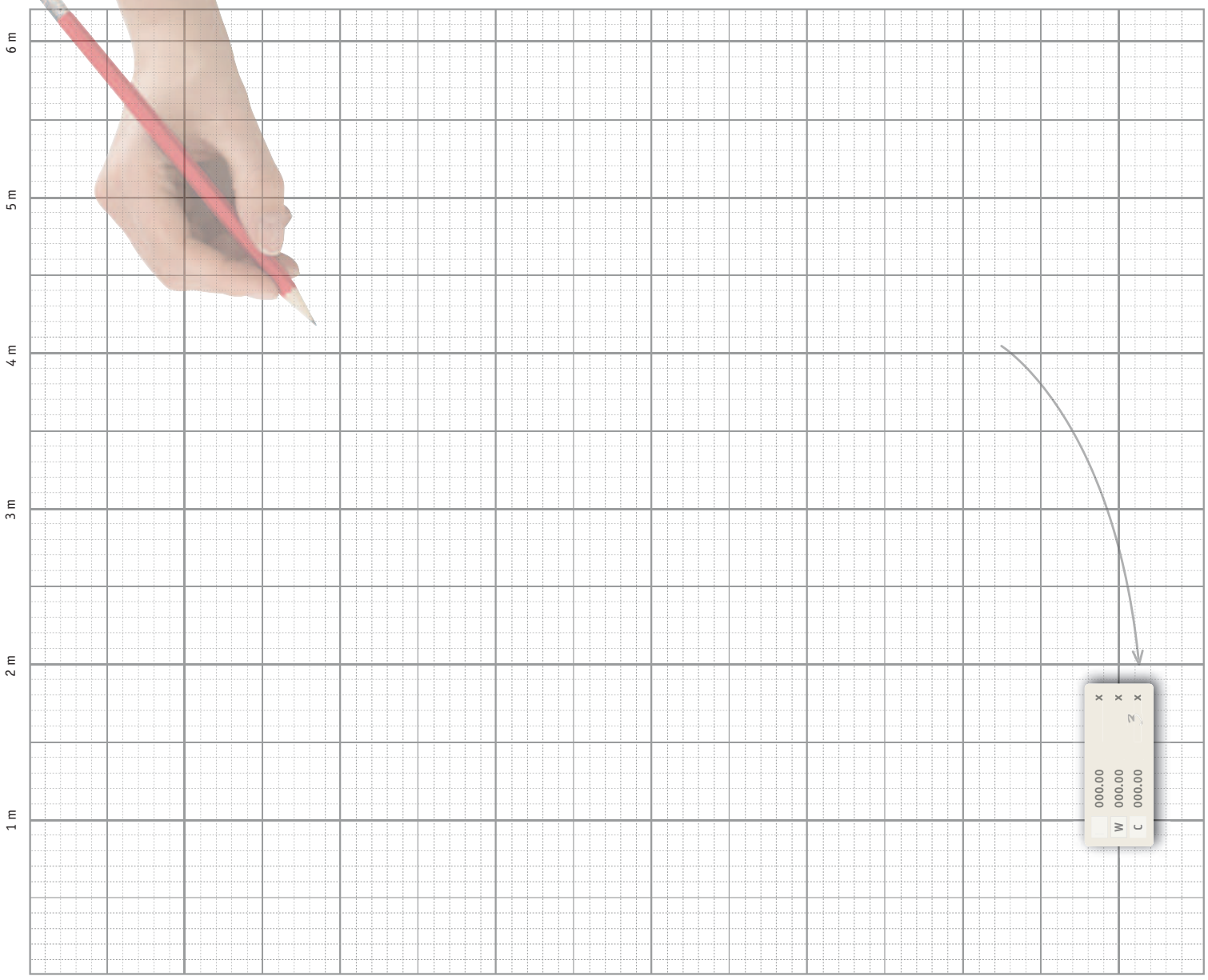

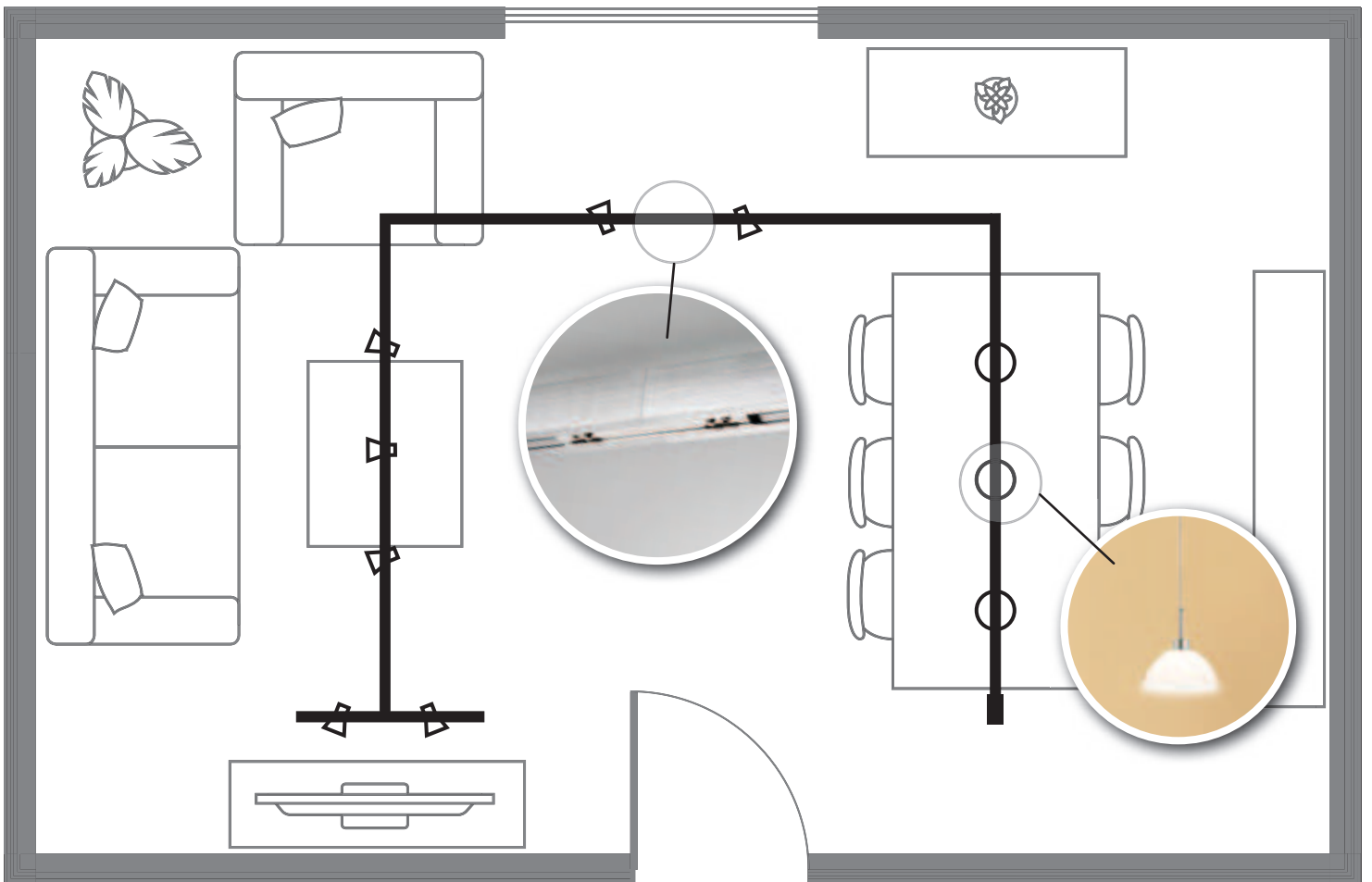

A+-A ①
 3 lm
 5 147mm

① Diese Leuchte enthält eingebaute LED-Lampen. Die Lampen können in der Leuchte nicht ausgetauscht werden.
 This luminaire contains built-in LED lamps. The lamps cannot be changed in the luminaire.
 Ce luminaire comporte des lampes à LED intégrées. Les lampes de ce luminaire ne peuvent pas être changées.

②a Diese Leuchte ist geeignet für Leuchtmittel der Energieklassen A+-E.
 This luminaire is compatible with bulbs of the energy classes A+-E.
 Ce luminaire est compatible avec des ampoules des classes énergétiques A+-E.

②b Diese Leuchte wird verkauft mit einem Leuchtmittel der Energieklasse A.
 This luminaire is sold with a bulb of the energy class A.
 Le luminaire est vendu avec une ampoule de la classe énergétique A.

A-E ②a
 3 lm, GU10 A ②b